

A collection of various door handle designs in brass and wood, arranged on a dark blue background. The designs include straight bars, curved bars, knobs, and levers. The 'momo handles' logo is visible in the top right corner.

Welcome to Reehal kitchens

Collection of Momo Handles

The Momo Handle range, distributed exclusively by Reehal kitchens, showcases a comprehensive and stunning range of cabinet handles created by experienced international designers.

Encompassing a wide range of styles from timeless classical to sleek modern, Momo Handles has something to satisfy every taste.

For more information please visit us at www.reehalkitchens.co.uk.



Contents

Contemporary D Handles	4
Contemporary Bow Handles	12
Contemporary Lip Pulls	16
Contemporary Pull Handles	22
Contemporary Knobs	28
Leather Handles	29
Timber Handles	30
Classical Collection	32
Cast Iron Collection	38
Antique Collection	44

Symbol Key

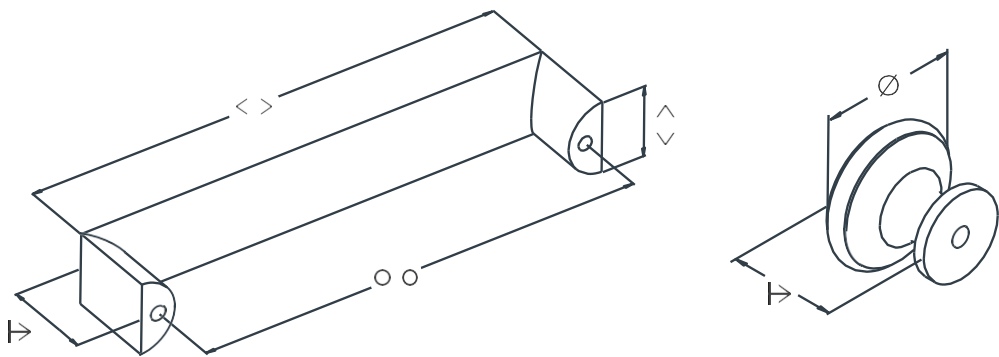

○ ○ < > ^
v ↳ ∅

○ ○ = Hole centre < > = Overall length ^
v = Width ↳ = Projection ∅ = Diameter



Graf

Knurled Textured Range

The aluminum handle Graf has evolved with a modern, industrial aesthetic. Its texture with a mesh-like shape ensures a perfect grip when you pull on it. The range fits perfectly well with kitchen or bathroom cabinetry, in changing rooms and in bedrooms. It comes in five different sizes and finishes available include Dull Brushed Nickel, Brushed Dark Brass and Brushed Black. The largest size is 1200mm which allows it to be fitted to cupboards and doors with large dimensions.



Brushed Dark Brass
(BDB)



Dull Brushed Nickel
(DBR)



Brushed Black
(BBL)

Description	Part no.	Finish	□ □	< >	^ v	↳
Cylinder	G0430.010	BDB, DBR, BBL	-	-	10	33
T Knob	G0430.060	BDB, DBR, BBL	-	60	10	33
D Handle	G0430.160	BDB, DBR, BBL	160	182	10	33
D Handle	G0430.256	BDB, DBR, BBL	256	278	10	33
D Handle	G0430.1178	BDB, DBR, BBL	1178	1200	10	33



Trento

Part no.	Finish	○○	<>	^ v	→
K230.160	ABN	160	172	14	35
K230.224	ABN	224	236	14	35
K230.352	ABN	352	364	14	35
K230.480	ABN	480	492	14	35



Pictured: Aluminium Brushed Nickel (ABN)

Kempton

Part no.	Finish	○○	<>	^ v	→
K250.160	ABN	160	170	24	37
K250.224	ABN	224	234	24	37
K250.352	ABN	352	362	24	37



Pictured: Aluminium Brushed Nickel (ABN)

Boston

Part no.	Finish	○○	<>	^ v	→
WFDH96	DBR	96	104	21	26
WFDH128	DBR	128	138	21	26
WFDH160	DBR	160	169	21	26
WFDH224	DBR	224	233	21	26
WFDH288	DBR	288	297	21	26

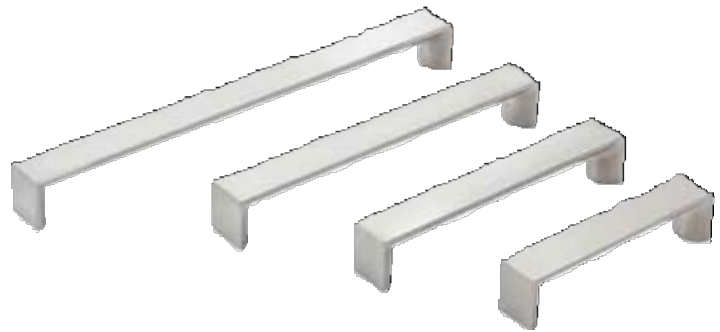

Pictured: Dull Brushed Nickel (DBR)

Torino

Part no.	Finish	○○	<>	^ v	→
M1755.128	BRN, CP	128	142	7	35
M1755.160	BRN, CP	160	174	7	35
WFDH224	BRN, CP	224	238	7	35

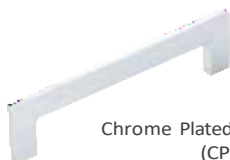

Chrome Plated (CP)



Pictured: Brushed Nickel (BRN)

Sense Mini

A simple rounded D handle with straight, minimalist lines, suited to a wide variety of cabinetry styles. Available in 2 sizes and Dull Brushed Brass, Dull Brushed Nickel and Matt Black



Pictured: Brushed Dark Brass (BDB)



Matt Black
(MBL)



Dull Brushed Nickel
(DBR)



Part no.	Finish	◯◯	<>	^ v	↳
SM0301.160	BDB, MBL, DBR	160	167	17	30
SM0301.256	BDB, MBL, DBR	256	263	17	30

Vieste

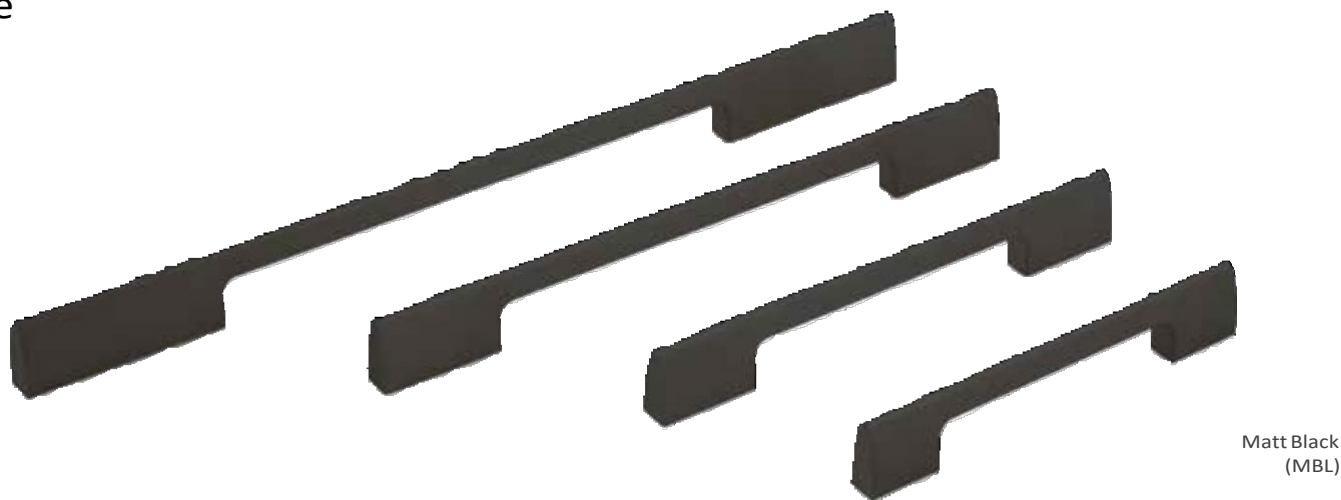

Matt Black (MBL)

Part no.	Finish	○○	<>	^ v	↳
SVA3822.128	MBL, ABN	128	148	11.6	27
SVA3822.160	MBL, ABN	160	180	11.6	27
SVA3822.224	MBL, ABN	224	244	11.6	27
SVA3822.320	MBL, ABN	320	340	11.6	27



Aluminium Brushed Nickel (ABN)

Sevilla

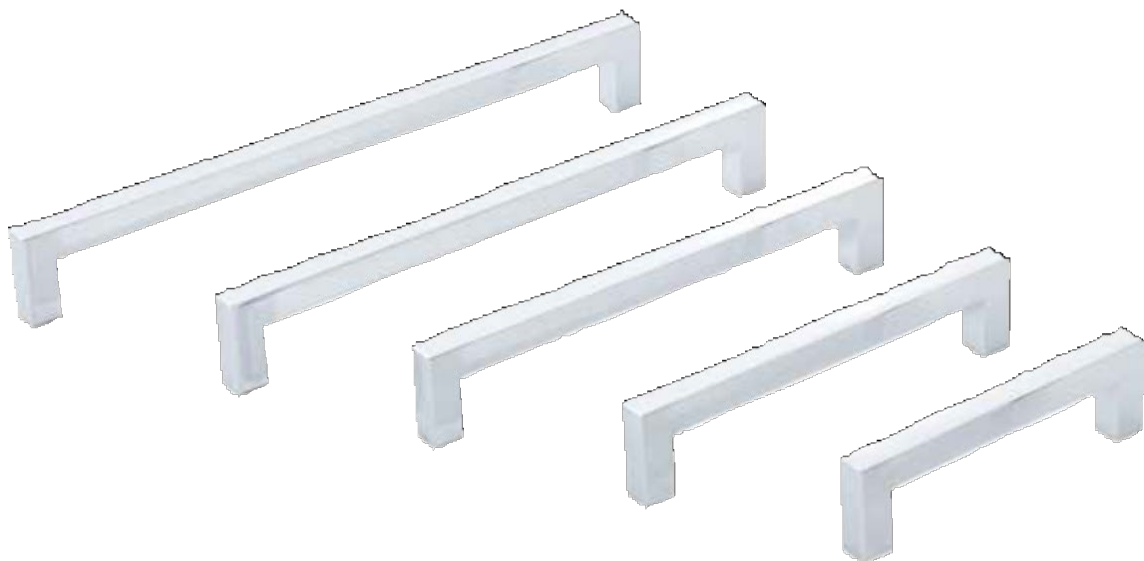

Pictured: Chrome Plated (CP)

Part no.	Finish	○○	<>	^ v	↳
K3201.96	CP, ABN, ALU	96	107	11	32
K3201.128	CP, ABN, ALU	128	139	11	32
K3201.160	CP, ABN, ALU	160	171	11	32
K3201.224	CP, ABN, ALU	224	235	11	32
K3201.288	CP, ABN, ALU	288	299	11	32



Aluminium (ALU)



Aluminium Brushed Nickel (ABN)

Livorno

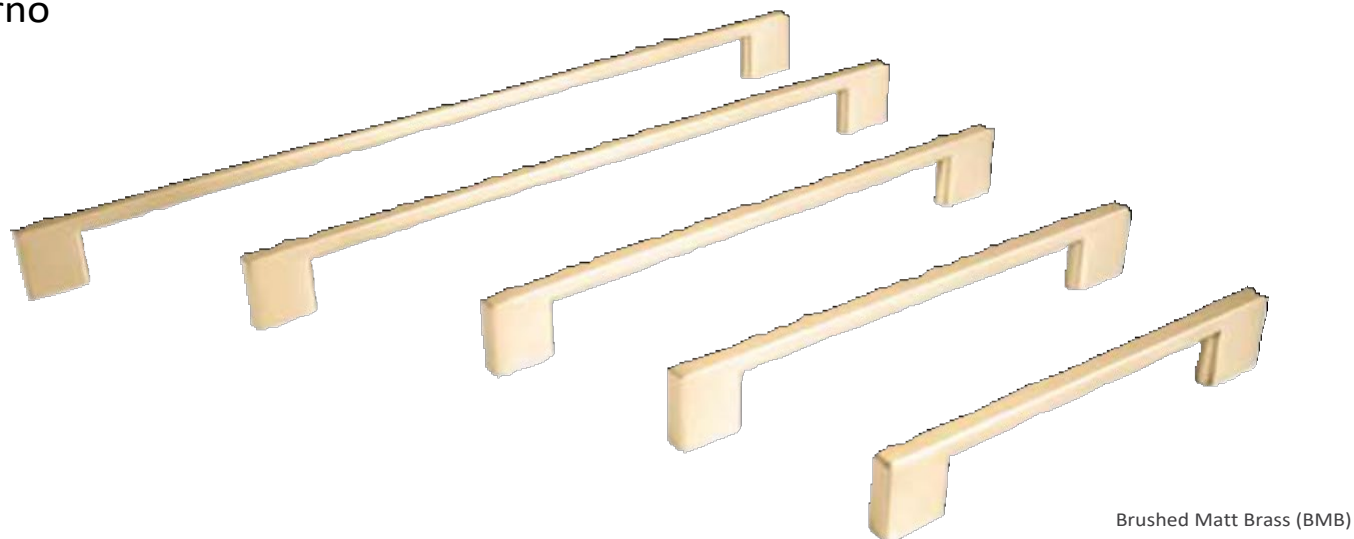

Part no.	Finish	○○	< >	^ v	↳
M3163.96	BMB, SC, DBR, MBL, MWH	96	120	8	26
M3163.128	BMB, SC, DBR, MBL, MWH	128	160	8	26
M3163.160	BMB, SC, DBR, MBL, MWH	160	192	8	26
M3163.192	BMB, SC, DBR, MBL, MWH	192	224	8	26
M3163.256	BMB, SC, DBR, MBL, MWH	256	288	8	26
M3163.320	BMB, SC, DBR, MBL, MWH	320	352	8	26

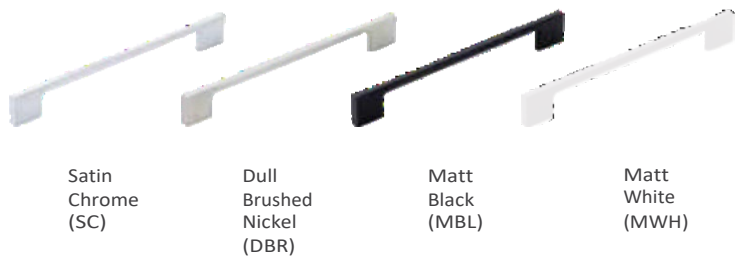

Dallas

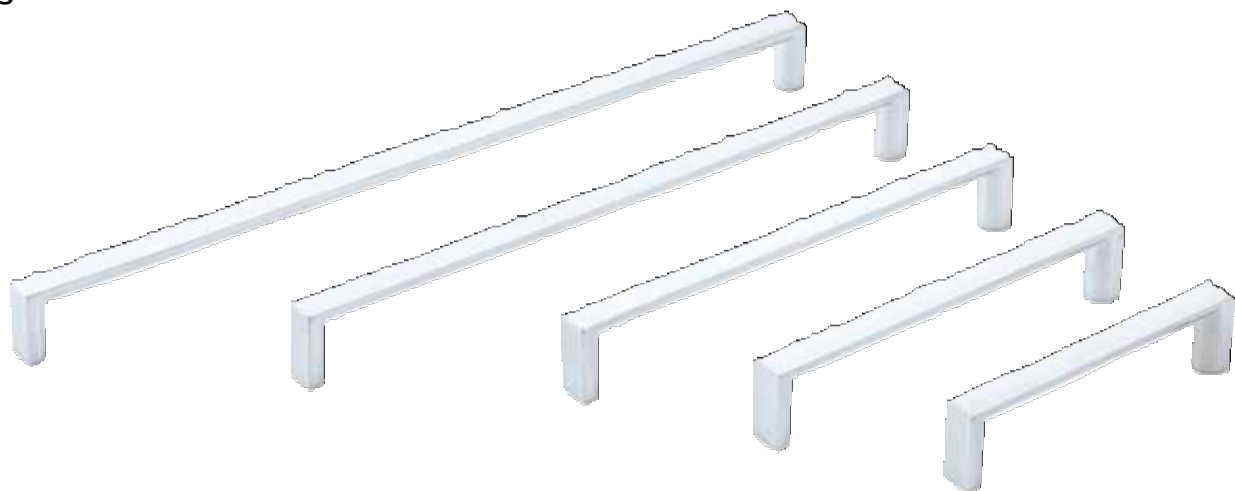

Part no.	Finish	○○	< >	^ v	↳
FDH96	SC,CP, DBR, MBL, MWH	96	104	12	26
FDH128	SC,CP, DBR, MBL, MWH	128	138	12	26
FDH160	SC,CP, DBR, MBL, MWH	160	169	12	26
FDH224	SC,CP, DBR, MBL, MWH	224	231	12	26
FDH288	SC,CP, DBR, MBL, MWH	288	297	12	26
FDH352	SC,CP, DBR, MBL, MWH	352	361	12	26
FDH448	SC,CP, DBR, MBL, MWH	448	457	12	26

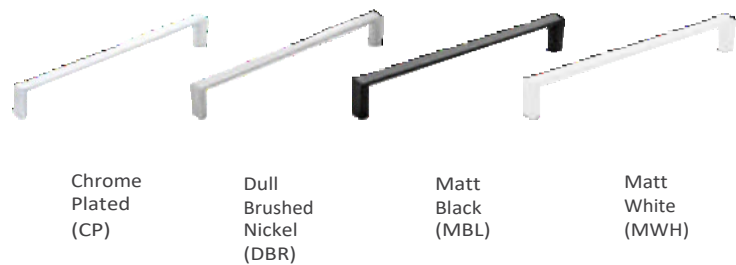

Milano

Part no.	Finish	○○	<>	^ v	↳
M1295.128	DBR, CP, MBL	128	136	8	28
M1295.160	DBR, CP, MBL	160	168	8	28
M1295.192	DBR, CP, MBL	192	200	8	28
M1295.320	DBR, CP, MBL	320	328	8	28

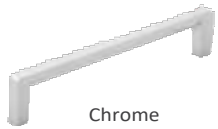

Chrome
Plated
(CP)

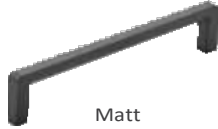

Matt
Black
(MBL)

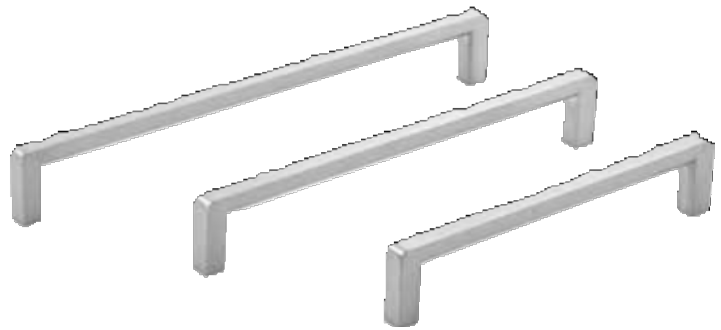

Dull Brushed Nickel
(DBR)

Bergamo

Part no.	Finish	○○	<>	^ v	↳
KHD96	SS	96	108	12	34
KHD128	SS	128	140	12	34
KHD160	SS	160	172	12	34
KHD224	SS	224	236	12	34
KHD288	SS	288	300	12	34
KHD352	SS	352	364	12	34
KHD480	SS	480	492	12	34
KHD608	SS	608	620	12	34

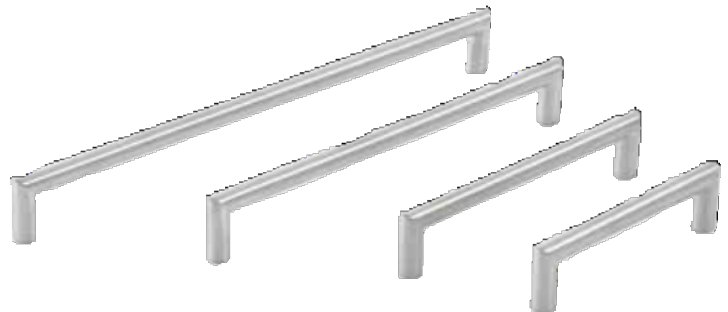

Stainless Steel
(SS)

Vigo

Part no.	Finish	○○	<>	^ v	↳
M367.128	BRN	128	138	14	35
M367.160	BRN	160	170	14	35
M367.224	BRN	224	234	14	35
M367.320	BRN	320	330	14	35



Brushed Nickel
(BRN)

Barletta

Part no.	Finish	○○	<>	^ v	↳
M2003.128	SS	128	148	14	34
M2003.160	SS	160	180	14	34
M2003.192	SS	192	212	14	34
M2003.288	SS	288	308	14	34
M2003.320	SS	320	340	14	34
M2003.480	SS	480	500	14	34



Stainless Steel
(SS)

Loreto

A simple yet classic bar handle that has been designed to suit a wide variety of cabinetry. Available in 2 lengths and a matching T knob, the Loreto comes in Polished Nickel, Brushed Nickel and Brushed Matt Brass.



Pictured: Polished Nickel (PN)



Brushed Matt Brass (BMB)



Brushed Nickel (BRN)



Description	Part no.	Finish	○ ○	< >	^ v	↳
T Knob	L8951.060	PN, BMB, BRN	-	60	23	34
D Handle	L8951.128	PN, BMB, BRN	128	165	23	34
D Handle	L8951.224	PN, BMB, BRN	224	260	23	34

Brave

Contemporary Bow Handle

A simple and stylish handle with a subtle curve perfect for contemporary cabinetry. The 992mm version has an off-centred bow for an elegantly dramatic look. Available in 5 sizes and Metallic Golden Brown, Metallic Grey and Matt Black.



Metallic Golden Brown
(MTBR)



Metallic Grey
(MTG)



Matt Black
(MBL)

Part no.	Finish	□ □	< >	^ v	↳
B0452.128	MTBR, MTG, MBL	128	160	8	25.5
B0452.192	MTBR, MTG, MBL	192	240	8	33
B0452.320	MTBR, MTG, MBL	320	400	8	33
B0452.992	MTBR, MTG, MBL	192/992	1040	8	33
B0452.1120	MTBR, MTG, MBL	192/1120	1150	8	33



B0452.992 has an off-centred bow



Caserta

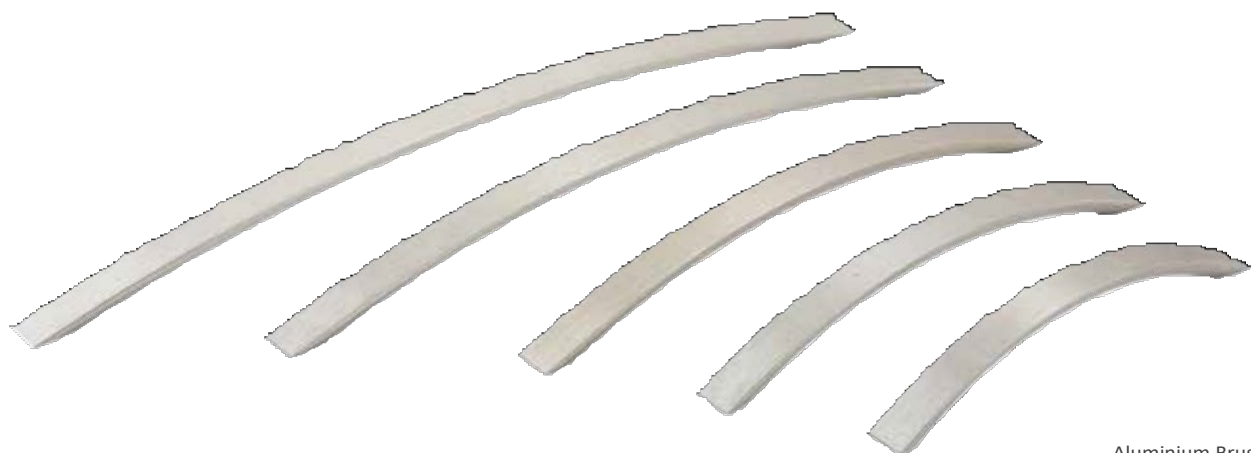

Aluminium BrushedNickel
(ABN)

Part no.	Finish	∘ ∘	< >	^ v	↳
MFBH160	ABN, ALU	160	189	20	30
MFBH192	ABN, ALU	192	228	20	30
MFBH224	ABN, ALU	224	264	20	30
MFBH288	ABN, ALU	288	341	20	30
MFBH352	ABN, ALU	352	417	20	30



Aluminium
(ALU)

Marsala



Brushed Nickel
(BRN)

Chrome Plated
(CP)

Part no.	Finish	∘ ∘	< >	^ v	↳
M1115.160	BRN, CP	160/192	210	8	29
M1115.288	BRN, CP	288/320	342	8	29

Brooklyn



Brushed Nickel
(BRN)

Chrome Plated
(CP)

Satin Chrome
(SC)

Part no.	Finish	∘ ∘	< >	^ v	↳
WHAH96	BRN, CP, SC	96	108	15	32
WHAH128	BRN, CP, SC	128	146	15	29

Feltre



Part no.	Finish	○○	<>	^ v	→
F0451.192	GRGY, BRN, MBL	192	218	12.4	32

Prato

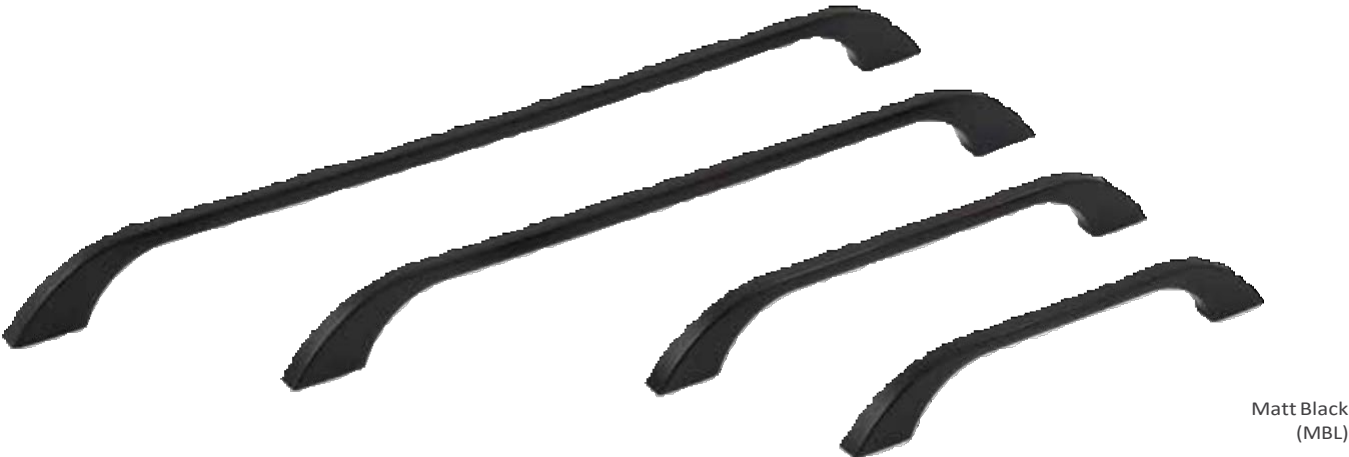

Part no.	Finish	○○	<>	^ v	→
PB978.128	MBL, DBR	128	165	8	27
PB978.160	MBL, DBR	160	198	8	27
PB978.256	MBL, DBR	256	295	8	27
PB978.320	MBL, DBR	320	359	8	27



Ona

Contemporary Lip Pull

The Ona is a comfortable, minimalist aluminium profile handle, whose shape ensures a perfect grip, making it easy to use. The profile is an embedded piece that is easy to install, as it is screwed on from the rear, which means that it adapts to different furniture widths. It is ideal on pillars and kitchen islands. Available in a brushed black, brushed grey, brushed nickel and in colours currently trending such as metallic grey and metallic golden brown.



Brushed Black
(BBL)



Metallic Golden Brown
(MTBR)



Brushed Grey
(BRG)



Metallic Grey
(MTG)



Dull Brushed Nickel
(DBR)

Part no.	Finish	□ □	< >	^ v	↳
ON0372.032	BBL, BRG, DBR, MTBR, MTG	32	50	18	42
ON0372.128	BBL, BRG, DBR, MTBR, MTG	128	200	18	42
ON0372.256	BBL, BRG, DBR, MTBR, MTG	256	350	18	42
ON0372.544	BBL, BRG, DBR, MTBR, MTG	544	600	18	42
ON0372.1056	BBL, BRG, DBR, MTBR, MTG	1056	1100	18	42



m m m m

Ferrara

A stainless steel profile handle with straight, clean lines for the contemporary kitchen. Screws to the rear of the door or drawer. Available in 5 sizes in Stainless Steel, Matt Black, Polished Stainless Steel and White.



Pictured: Stainless Steel (SS)



Matt Black
(MBL)

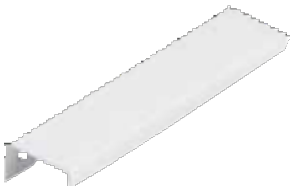

White
(WH)



Polished Stainless Steel
(PSS)



Part no.	Finish	□ □	< >	^ v	→
FER038	SS, MBL, WH, PSS	32	38	20	35
FER100	SS, MBL, WH, PSS	88	100	20	35
FER150	SS, MBL, WH, PSS	128	150	20	35
FER200	SS, MBL, WH, PSS	160	200	20	35
FER300	SS, MBL, WH, PSS	265	300	20	35

Vann

A profile handle with straight, modern lines for the contemporary kitchen. Screws to the rear of the door or drawer. Available in 4 sizes in Brushed Dark Brass, Dull Brushed Nickel, Matt Black.

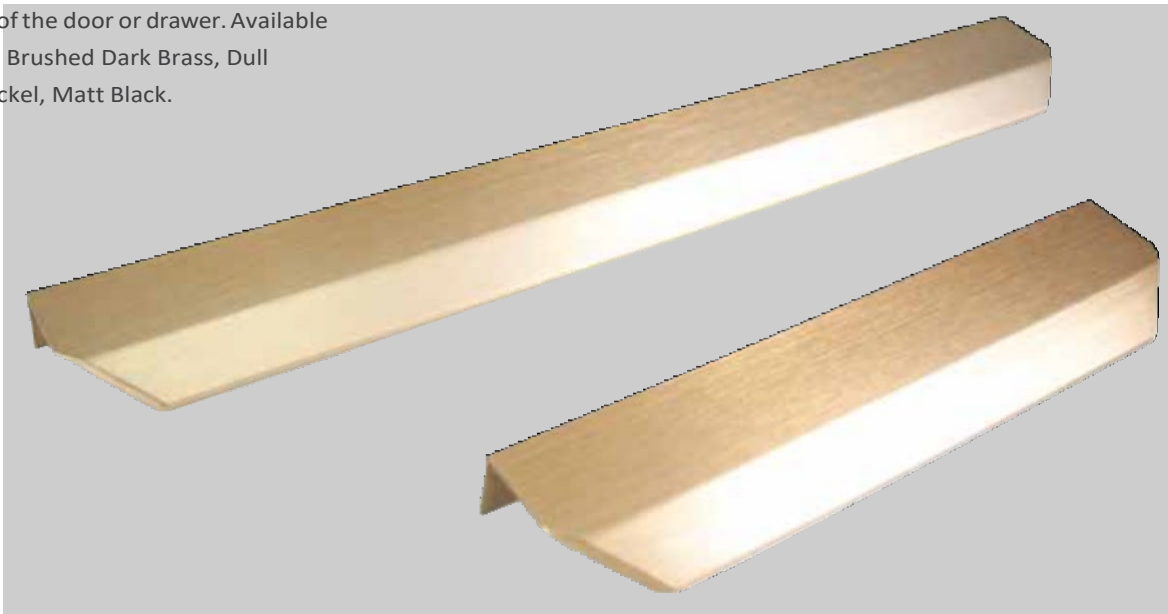

Pictured: Brushed Dark Brass (BDB)

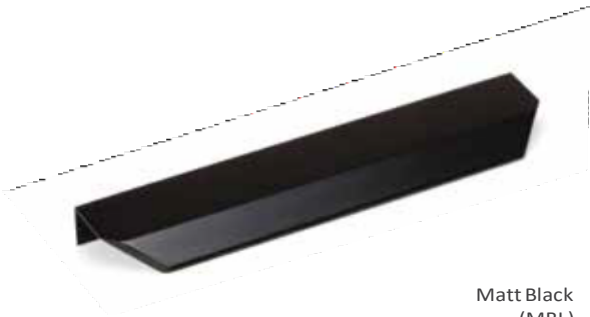

Matt Black (MBL)



Dull Brushed Nickel (DBR)



Part no.	Finish	□□	<>	^ v	→
V0375.064	BDB, MBL, DBR	64	100	19.7	44
V0375.128	BDB, MBL, DBR	128	200	19.7	44
V0375.256	BDB, MBL, DBR	256	350	19.7	44
V0375.1120	BDB, MBL, DBR	1120	1200	19.7	44

Vector

An ergonomic profile handle with rounded edges, perfect for any cabinet. Suits 19mm door with rebate fixing. Available in 3 sizes in Brushed Black and Dull Brushed Nickel.



Pictured: Brushed Black (BBL)



Dull Brushed Nickel (DBR)



Part no.	Finish	oo	< >	^ v	→
V0434.197	BBL, DBR	-	197	12	41
V0434.297	BBL, DBR	-	297	12	41
V0434.397	BBL, DBR	-	397	12	41

Noma

The undulating shape of the aluminium Noma handle and its graceful lines make it an outstanding feature in kitchen and bathroom interior design of all kinds. Its aesthetic harmony and originality make it an eye-catching feature. Its wave-like design really stands out on cabinets and drawers. Simply screws to the rear of the door or drawer.

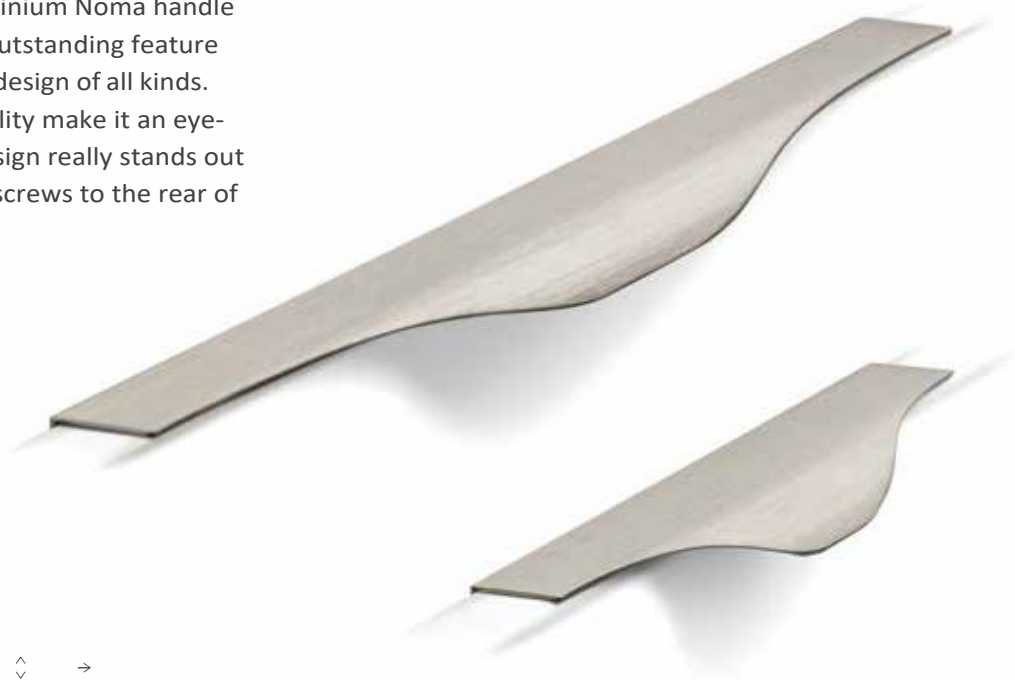

Part no.	Finish	□ □	< >	^ v	→
N0254.128	DBR	128	200	17	38
N0254.256	DBR	256	350	17	38

Pictured: Dull Brushed Nickel (DBR)



Angle

Contemporary Pull Handle

The Angle handle is made with an aluminium profile, and is characterised by its straight lines and its wedge-shaped front part, which lends it a timeless look that can be combined with all current furnishing trends. Its design and many different sizes are so practical and versatile that they can be fitted on a diverse range of cabinetry.



Metallic Grey
(MTG)



Metallic Golden Brown
(MTBR)

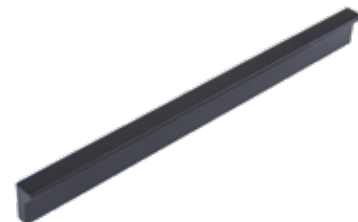

Matt Black
(MBL)



Dull Brushed Nickel
(DBR)

Part no.	Finish	□ □	< >	^ v	↳
A0077.64	MTG, MTBR, MBL, DBR	64	100	11	20
A0077.128	MTG, MTBR, MBL, DBR	128	200	11	20
A0077.192	MTG, MTBR, MBL, DBR	192	300	11	20
A0077.480	MTG, MTBR, MBL, DBR	480	600	11	20
A0077.640	MTG, MTBR, MBL, DBR	640	900	11	20



Cutt

A contemporary handle with a modern, robust shape that is highly functional. Ideal for mounting near the edge of the door or in the usual centred position. Available in 3 sizes in Matt Black and Dull Brushed Nickel.



Pictured: Matt Black (MBL)



Dull Brushed Nickel (DBR)



Part no.	Finish	□ □	< >	^ v	→
C0322.096	MBL, DBR	96	200	17.5	23
C0322.192	MBL, DBR	192	400	17.5	23
C0322.320	MBL, DBR	320	600	17.5	23

Brikk

A contemporary and versatile handle with gentle curves that looks great mounted horizontally as well as vertically. Available in 3 sizes and Dull Brushed Nickel and Antique Bronze.

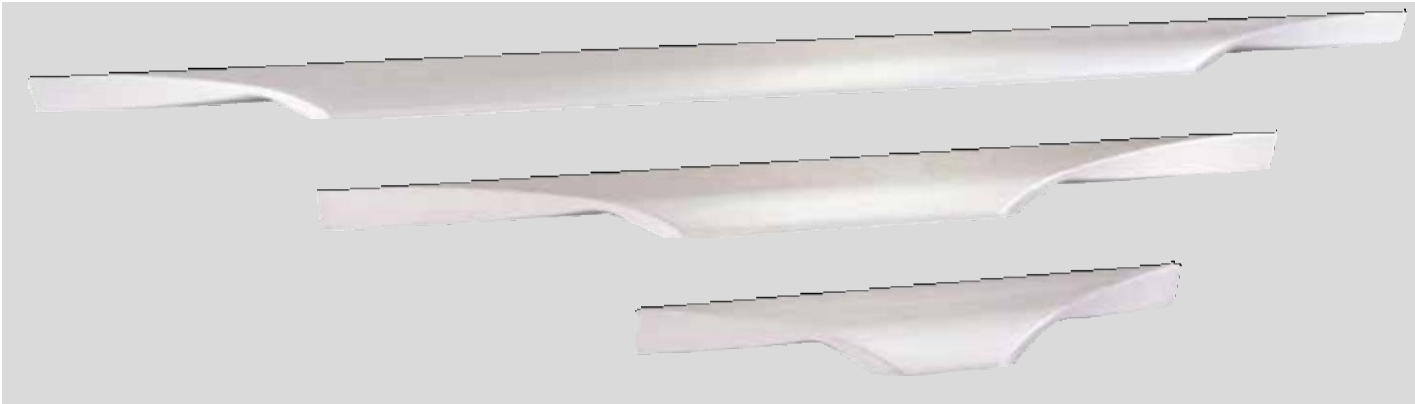

Pictured: Dull Brushed Nickel (DBR)



Antique Bronze (ABR)



Part no.	Finish	□□	<>	^ v	→
B0334.032	DBR, ABR	32	140	14	27
B0334.160	DBR, ABR	160	290	14	27
B0334.192	DBR, ABR	192	490	14	27

Nick



Brushed Matt Brass
(BMB)

Part no.	Finish	○○	< >	^ v	↳
N0373.032	BMB, BRN	32	50	13	24
N0373.160	BMB, BRN	160	178	13	24



Brushed Nickel
(BRN)

Alta



Matt Black
(MBL)

Part no.	Finish	○○	< >	^ v	↳
A0705.160	ABN, MBL	160	179	10	35
A0705.224	ABN, MBL	224	243	10	35
A0705.320	ABN, MBL	320	339	10	35

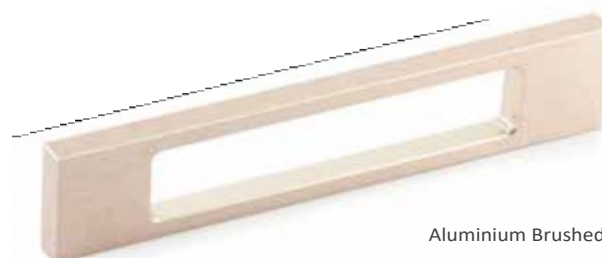

Aluminium Brushed Nickel
(ABN)

Sirolo

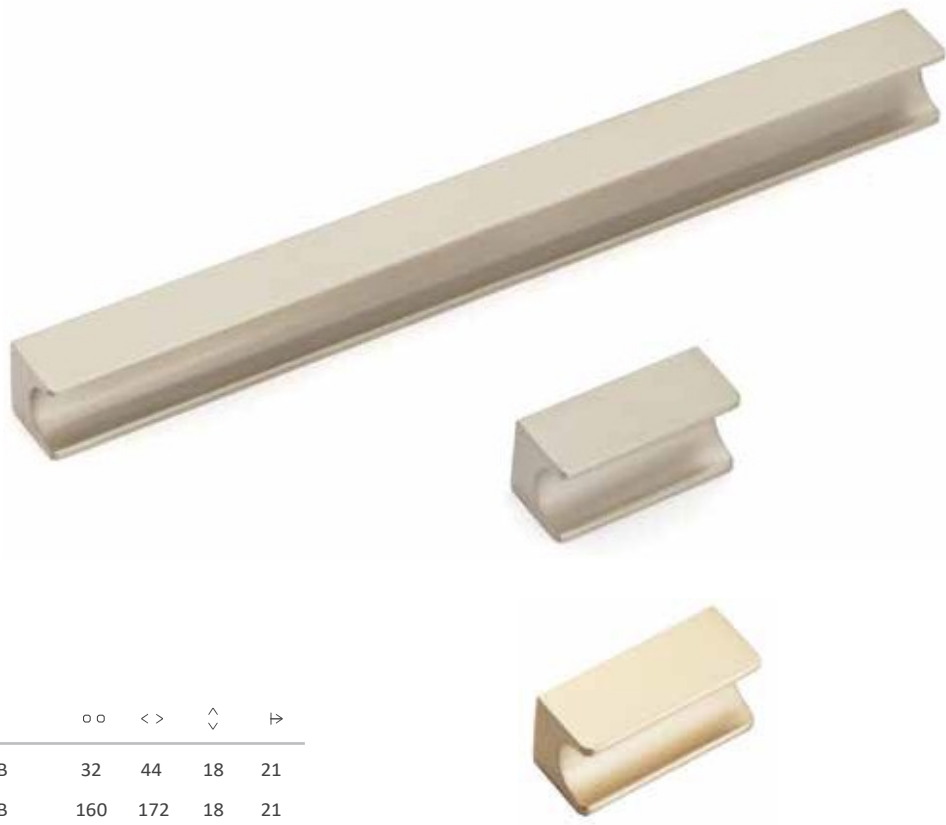

Brushed Nickel
(BRN)

Brushed Matt Brass
(BMB)

Part no.	Finish	○ ○	< >	^ v	↳
S1700.032	BRN, BMB	32	44	18	21
S1700.160	BRN, BMB	160	172	18	21

Turin



Brushed Matt Black
(BRMBL)

Part no.	Finish	○ ○	< >	^ v	↳
CM1205.096	BRMBL	96	187	20	24
CM1205.160	BRMBL	160	251	20	24

Evora



Matt Black (MBL)

Part no.	Finish	○○	< >	^ v	→
DC1219	MBL, SC, SN	-	19Ø	-	20
DC1226	MBL, SN	-	26Ø	-	27

Como



Part no.	Finish	○○	< >	^ v	→
C0168.028	BRN, MBL	-	26Ø	-	18

Asti

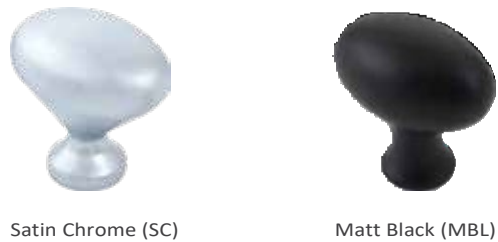

Satin Chrome (SC)

Matt Black (MBL)



Chrome Plated (CP)

Brushed Nickel (BRN)

Part no.	Finish	○○	< >	^ v	→
OKS	SC, MBL, CP, BRN	-	30	19	32
OKL	SC, BRN, CP	-	32	22	32

Lugo

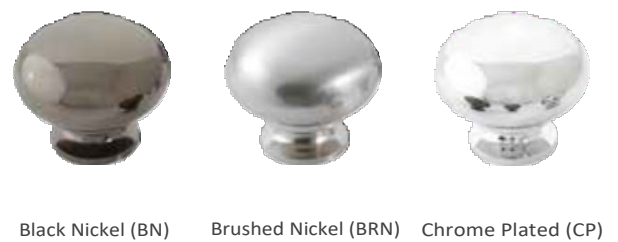

Black Nickel (BN)

Brushed Nickel (BRN)

Chrome Plated (CP)



Polished Brass (PB)

Satin Chrome (SC)

Part no.	Finish	○○	< >	^ v	→
3230	BN, BRN, CP, PB, SC	-	30Ø	-	27
3238	BN, BRN, CP, PB, SC	-	38Ø	-	31

Flexa

The Flexa range, made in leather, gives a warm, organic touch to whatever piece of cabinetry it may be fitted to. Available in three leather colours and the option of Brass and Pewter buttons.



Brass Button

Pewter Button



Pictured: Black Leather with Brass Buttons



Light Tan



Dark Brown



Part no.	Finish	oo	<>	^ v	→
F0404.070	BLBB, BLPW, LTBB, LTPW, DBBB, DBPW	-	22	70	24
F0404.160	BLBB, BLPW, LTBB, LTPW, DBBB, DBPW	160	182	22	27

Calin



Part no.	Finish	○○	< >	^ v	↳
C0165.160	OWG, BWG	160	240	30	30

Echo



Part no.	Finish	○○	< >	^ v	↳
E0166.060	OWG, BWG	-	60Ø	-	22

Balto



Part no.	Finish	○○	< >	^ v	↳
B0167.060	OWG, BWG	16	60	60	22

Barcco

A wooden profile handle available in Natural Ash and Walnut that works equally well in horizontal or vertical positions. Available in 2 sizes.



Pictured: Natural Ash (NA)



Walnut (WN)



Part no.	Finish	□ □	< >	^ v	→
B0340.160	NA, WN	160	200	18	33
B0340.320	NA, WN	320	400	18	33



New Hampton

Classic Handle Range

This classic handle range has been redefined and now includes even more beautiful finishes. Whilst created to suit the Hamptons style, New Hampton compliments a wide variety of kitchen and cabinets.



Bronze
(BNZ)



Matt Black
(MBL)



Dull Brushed Nickel
(DBR)



Polished Nickel
(PN)

Description	Part no.	Finish	o o	< >	^ v	↳
Knob	NHMK032	BNZ, MBL, DBR, PN	-	32Ø	-	36
Cup Pull	NHMC096	BNZ, MBL, DBR, PN	96	123	39	20
D Handle	NHMD160	BNZ, MBL, DBR, PN	160	168	17	26



Catona



Polished Nickel (PN)



Matt Black (MBL)



Brushed Matt Brass (BMB)



Brushed Nickel (BRN)

Part no.	Finish	□ □	< >	^ v	→
C1937.032	PN, MBL, BMB, BRN	-	32Ø	-	37

Pellaro



Polished Nickel (PN)



Matt Black (MBL)



Brushed Matt Brass (BMB)



Brushed Nickel (BRN)

Part no.	Finish	□ □	< >	^ v	→
P1915.032	PN, MBL, BMB, BRN	-	32Ø	-	32

Salvano



Part no.	Finish	□ □	< >	^ v	↳
S8884.160	PN, MBL, BMB, BRN	160	198	25	20

Bosco



Part no.	Finish	□ □	< >	^ v	↳
B1959.032	PN, MBL, BMB, BRN	-	32Ø	-	30

Georgia

A classic refined handle range to suit a variety of cabinetry styles.



Pictured: Chrome Plated (CP)



Brushed Nickel (BRN)



Description	Part no.	Finish	□□	<>	^ v	↳
Knob	KB3840.32	CP, BRN	-	32	32	28
Cup Pull	HN3843.96	CP, BRN	96	145	41	27
D Handle	HN3841.128	CP, BRN	128	177	24	28
D Handle	HN3841.224	CP, BRN	224	268	24	28

Huntington

A classic handle range ideally suited to Hamptons style of cabinetry.



Pictured: Brushed Nickel (BRN)



Chrome Plated (CP)



Description	Part no.	Finish	∘ ∘	< >	^ v	↔
Knob	KB3383.32	BRN, CP	-	30	30	25
Cup Pull	HN7003.96	BRN, CP	96	124	38	20
D Handle	HN3384.128	BRN, CP	128	146	20	26
D Handle	HN3384.192	BRN, CP	192	212	20	26



Emma

Cast Iron Handle Range

A beautiful cast iron bar handle available in two stunning finishes perfectly complimenting a luxury traditional kitchen. Available in 7 sizes in Natural Iron and Aged Antique Brass.



Natural Iron
(NI)



Aged Antique Brass
(AAB)

Description	Part no.	Finish	⌀	< >	^ v	↳
Knob	TKNB230.35	NI, AAB	-	35	18	26
Knob	TKNB230.58	NI, AAB	32	58	18	26
D Handle	TPB230.96	NI, AAB	96	130	18	26
D Handle	TPB230.128	NI, AAB	128	162	18	26
D Handle	TPB230.160	NI, AAB	160	195	18	26
D Handle	TPB230.224	NI, AAB	224	262	18	26
D Handle	TPB230.320	NI, AAB	320	355	18	26



Windsor



Pewter
(PW)

Description	Part no.	Finish	□□	<>	^ v	↳
Knob	KB3951.34	PW	-	34	34	34
D Handle	HN3952.128	PW	128	151	24	28
D Handle	HN3952.160	PW	160	185	24	28

Winchester



Pewter
(PW)

Description	Part no.	Finish	□□	<>	^ v	↳
Knob	KB3983.34	PW	-	34Ø	-	28
D Handle	HN3984.128	PW	128	143	15	36
D Handle	HN3984.160	PW	160	175	15	36

Montrose



Pewter (PW)

Description	Part no.	Finish	□ □	< >	^ v	↳
Knob	KB3885.32	PW	-	32Ø	-	35
D Handle	HN3887.128	PW	128	149	20	39
D Handle	HN3887.203	PW	203	234	20	43

Bordeaux



Pewter (PW)

Description	Part no.	Finish	□ □	< >	^ v	↳
Knob	KB3624.35	PW	-	35Ø	-	37
T Knob	KB3625.90	PW	-	90	25	42
D Handle	HN3626.128	PW	128	153	25	40
D Handle	HN3626.203	PW	203	229	25	52

Tomi



Natural Iron
(NI)

Description	Part no.	Finish	○○	<>	^ v	↳
Round Knob	TKNB280.30	NI	-	33Ø	-	31
T Knob	TTKNB280.90	NI	-	90	26	53
D Handle	TDH280.128	NI	128	155	26	41
D Handle	TDRH280.224	NI	224	252	64	30
D Handle	TDRH280.320	NI	320	338	64	30

George



Pewter
(PW)

Description	Part no.	Finish	○○	<>	^ v	↳
Knob	KB3849.32	PW	-	32	32	28
Cup Pull	HN3851.96	PW	96	145	41	27
D Handle	HN3850.128	PW	128	177	24	28
D Handle	HN3850.224	PW	224	268	24	28

Crosby



Pewter
(PW)

Description	Part no.	Finish	⊙ ⊙	< >	^ v	↳
Knob	TJ3738.34	PW	-	34∅	-	29
Knob	TJ3738.38	PW	-	38∅	-	34
D Handle	TJ3741.128	PW	128	154	26	47
D Handle	TJ3741.224	PW	224	250	26	47

Valencia



Pewter
(PW)

Part no.	Finish	⊙ ⊙	< >	^ v	↳
TC3257.34	PW	-	34	34	25
TC3853.128	PW	128	172	35	26

Iron Bridge



Natural Iron
(NI)

Description	Part no.	Finish	⊙ ⊙	< >	^ v	↳
Knob	TKNB120.32	NI	-	32∅	-	21
D Handle	TBP120.128	NI	128	137	18	27
D Handle	TBP120.203	NI	203	211	18	30
D Handle	TBP120.305	NI	305	311	18	30



Florescia

Traditional Handle Range

A comprehensive handle range that includes a wide range of finishes and styles to suit traditional kitchens and cabinets. Available in 4 styles in Charcoal, European Pewter, Matt Black, Champagne, Antique Brass and Antique Copper.



Description	Part no.	Finish	○○	< >	^ v	→
Plain Knob	CTMK	CH, EPW, MBL, CHM, AB, AC	-	29Ø	-	33
Concentric Knob	CTCK	CH, EPW, MBL, CHM, AB, AC	-	33Ø	-	26
Cup Pull	CTCP	CH, EPW, MBL, CHM, AB, AC	64	104	29	25
Bow Handle	CTRP	CH, EPW, MBL, CHM, AB, AC	76	138	21	25



Button

For matching knobs see our Duke range.

Matt Black (MBL)

Pewter (PW)

Antique Brass (AB)

Part no.	Finish	□ □	< >	^ v	↳
B0410.160	MBL, PW, AB	160	175	17	25

Redo

For matching knobs see our Duke range.

Antique Brass (AB)

Brushed Nickel (BRN)

Pewter (PW)

Part no.	Finish	□ □	< >	^ v	↳
R0226.128	AB, BRN, PW	128	137	15	32
R0226.192	AB, BRN, PW	192	201	15	32

Aura

For matching knobs see our Duke range.



Antique Silver (AS)

Part no.	Finish	□□	<>	^ v	↳
A0391.064	AS	64	87	28	22

Orion

For matching knobs see our Duke range.



Antique Silver (AS)

Part no.	Finish	□□	<>	^ v	↳
OR0392.128	AS	128	136	17	23

Duke

These Duke knobs compliment the Button, Redo, Aura and Orion handles.



Part no.	Finish	□□	<>	^ v	↳
D0393.31	MBL, BRN, PW, AS, AB	-	31Ø	-	25.5

Royale



Pewter
(PW)

Antique Brass
(AB)

Description	Part no.	Finish	○ ○	< >	^ v	→
Tear Drop	T89.070	PW, AB	-	28	70`	24
Cup Pull	T89.064	PW, AB	64	97	53	24
Bow Handle	T89.096	PW, AB	96	138	28	26

Sovereign



Antique Brass
(AB)

Description	Part no.	Finish	○ ○	< >	^ v	→
Hook	T85.085	AB, PW	-	79	89	36
Knob	T85.038	AB, PW	-	37	37	24
T Knob	T85.050	AB, PW	-	50	21	24
Cup Pull	T85.064	AB, PW	64	100	35	25
D Handle	T85.128	AB, PW	128	165	32	28
D Handle	T85.160	AB, PW	160	198	32	28

Pewter
(PW)

Varese

Varese is a vintage-inspired range designed to suit a wide variety of cabinetry. Available in 12 sizes in Black and Pewter.



Pictured: Black (BL)



Pewter
(PW)

Description	Part no.	Finish	□○	<>	^ v	↳
Round Knob	BVRK35	BL, PW	-	35Ø	-	50
T Knob	BVK50	BL, PW	-	51	20	34
T Knob	BVK70	BL, PW	-	69	22	37
T Knob	BVK90	BL, PW	-	90	31	52
D Handle	BVD96	BL, PW	96	104	20	39
D Handle	BVD128	BL, PW	128	137	20	39
D Handle	BVD160	BL, PW	160	168	20	39
Swivel Bail	BVS96	BL, PW	96	116	47	30
Swivel Bail	BVS128	BL, PW	128	150	47	30
Swivel Bail	BVS160	BL, PW	160	180	47	30
Swivel Bail	BVS192	BL, PW	192	215	47	30
Swivel Bail	BVS224	BL, PW	224	248	47	30



Kansas



Pictured: Antique Aqua (AAQ)



Antique Cream (ACR)



Description	Part no.	Finish	□ □	< >	^ v	↳
Oval Knob	T114	AAQ, ACR	-	35	16	24
Square Knob	T226.024	AAQ, ACR	-	25	25	22
Bow Handle	T214.096	AAQ, ACR	96	126	18	24
Bow Handle	T214.128	AAQ, ACR	128	165	18	24
D Handle	T226.096	AAQ, ACR	96	114	18	22
D Handle	T226.128	AAQ, ACR	128	145	18	22
D Handle	T226.192	AAQ, ACR	192	210	18	22

Trianon



White Crackle with Pewter (WHCRPW)

Cream Crackle and Antique Brass (CRCRAB)

Description	Part no.	Finish	○○	<>	^ v	↳
Round Knob	TCM3620	WHCRPW, CRCRAB, WHBRN	-	35Ø	-	32
T Knob	TCM3621	WHCRPW, CRCRAB, WHBRN	-	90	25	42
D Handle	TCM3622	WHCRPW, CRCRAB, WHBRN	128	154	25	40
Swivel Bail	TCM3623.224	WHCRPW, CRCRAB, WHBRN	224	245	63	32



White and Brushed Nickel (WHBRN)

Marbella



Mother of Pearl and European Pewter (MOPEPW)

Description	Part no.	Finish	○○	<>	^ v	↳
Round Knob	TP04.32	MOPEPW	-	32Ø	-	25
Oval Knob	TP01.40	MOPEPW	-	41	25	34
Round D	TM10.96	MOPEPW	96	125	20	31
Square D	TM22.96	MOPEPW	96	122	20	29



momo
handles

www.momohandles.com.au